

# MODERN ART OXFORD

## VISITOR ACCESS STATEMENT

Modern Art Oxford is a leading UK contemporary art space with an international reputation for inspirational and innovative programmes. The gallery is located in central Oxford and provides free entry for all.

This access statement is to help inform and advise all Modern Art Oxford visitors of the facilities and services that we offer to the public.

### Planning your visit



The gallery is a 0.3 mile from Gloucester Green bus station.

[www.oxfordbus.co.uk](http://www.oxfordbus.co.uk)

---



The gallery is a 0.6 mile walk from Oxford's mainline rail station, where direct trains run from London Paddington every thirty minutes.

[www.nationalrail.co.uk](http://www.nationalrail.co.uk)

---



Park and ride services are recommended if driving to Oxford as parking in the city is limited.

[www.parkandride.oxfordbus.co.uk](http://www.parkandride.oxfordbus.co.uk)

---



Details of Oxford car parks are available at [www.oxford.gov.uk/carparks](http://www.oxford.gov.uk/carparks)



There are three parking spaces for blue badge holders in close proximity to the gallery entrance on St Ebbe's Street  
<http://bit.ly/2Hf733C>

## Visiting Modern Art Oxford

The gallery's main entrance is on Pembroke Street, with level access through the central automatic doors followed by seven steps or a platform lift on the left-hand side.

There is also an entrance through our Yard on St Ebbe's Street with level access up a gradual slope and through automatic doors into the Shop.

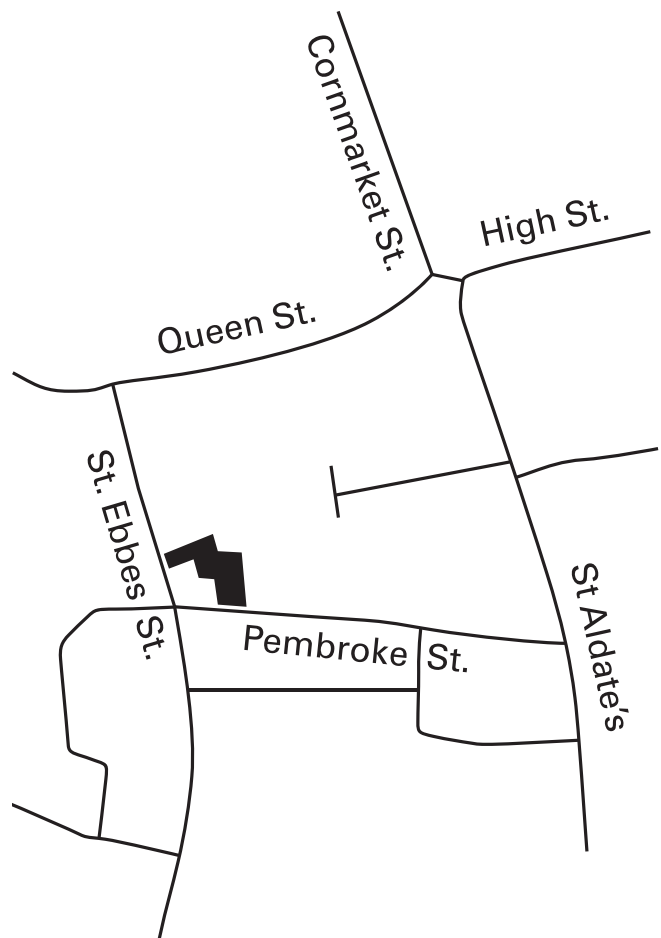

## Lift access

Modern Art Oxford's public spaces are set over three floors, and we have stair-free access to all our floors. The entrance on St Ebbe's Street is at street level, and there is a platform lift at the Pembroke Street entrance.

Our passenger lift is located in the café and goes to the galleries and the basement. The lift dimensions are 130cm wide by 140cm deep (and 230cm high). The clear door opening is 85cm wide, and the max weight in the lift is 800kg (8 persons).

## MODERN ART OXFORD

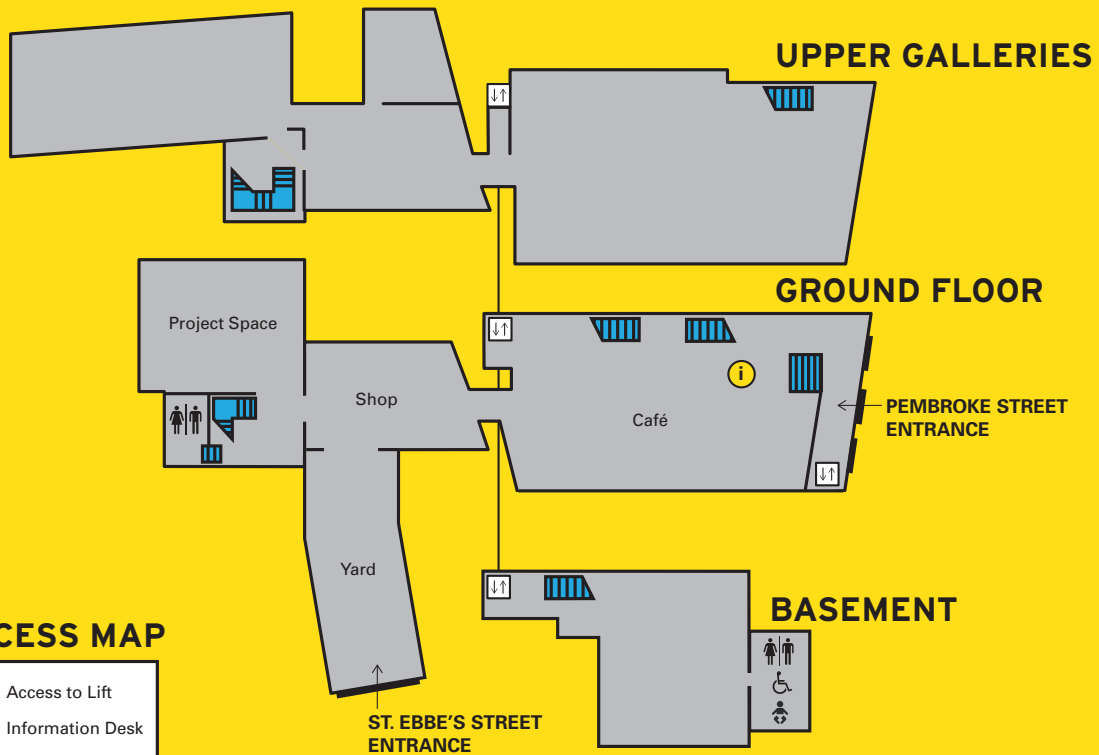

Information Desk staff will be happy to assist you and provide additional information on accessibility at the gallery.



Large print exhibition guides and information for visitors with visual impairments is available from our Information Desk. These guides are also kept in the galleries.



A wheelchair for visitors with limited mobility can be booked in advance of your visit.

Portable folding stools are also available.



The Information Desk and Shop can provide induction loops for visitors with hearing impairments.



Toilets are located in the basement and down 3 steps adjacent to the shop on the ground floor.

---



Baby changing facilities are located in the accessible toilet in the Basement.

---



Guide dogs, hearing and registered assistance dogs are welcome.

---



St Ebbe's Street is at street level, platform lift at Pembroke Street entrance. Passenger lift goes to all floors. Dimensions 130cm x 140cm (230cm high). Clear door opening is 85cm wide, max weight in the lift is 800kg (8 persons).

---



We are an Autism friendly venue and offer relaxed tours. We have a Welcome & Journey Pack that can be provided. These guides are available by getting in touch with [info@modernartoxford.org.uk](mailto:info@modernartoxford.org.uk).

Modern Art Oxford does not operate a cloakroom or locker service.

If you have any queries or require assistance before your visit, please call 01865 722 733 or email [info@modernartoxford.org.uk](mailto:info@modernartoxford.org.uk).

## Exhibitions

Modern Art Oxford's exhibitions change throughout the year and visitors with any concerns regarding seating, lighting or suitability of the current exhibitions are advised to call the Information Desk for details before their visit.

Exhibitions and most public events are free unless otherwise stated. For more information please visit [www.modernartoxford.org.uk](http://www.modernartoxford.org.uk).

## Contact us

Modern Art Oxford  
30 Pembroke Street  
Oxford  
OX1 1BP

+44 (0)1865 722 733  
[info@modernartoxford.org.uk](mailto:info@modernartoxford.org.uk)  
[www.modernartoxford.org.uk](http://www.modernartoxford.org.uk)

## Useful information

### [Oxford City Council accessibility guide](#)

#### Buses

[www.oxfordbus.co.uk](http://www.oxfordbus.co.uk) 01865 785400

[www.stagecoachbus.com](http://www.stagecoachbus.com) 01865 772250

#### Park and ride

[www.parkandride.oxfordbus.co.uk](http://www.parkandride.oxfordbus.co.uk)

#### Car parks

[www.oxford.gov.uk/carparks](http://www.oxford.gov.uk/carparks)

#### Trains

[www.nationalrail.co.uk](http://www.nationalrail.co.uk) 03457 484 950

#### Taxis

[www.001taxis.com](http://www.001taxis.com) 01865 240 000

[www.royal-cars.com](http://www.royal-cars.com) 01865 777 333

[www.oxfordcars.co.uk](http://www.oxfordcars.co.uk) 01865 406 070

## Accessibility feedback

Modern Art Oxford welcomes your feedback to help improve our offer to all members of the public. Please take a moment to tell us how we did by filling out a comments card at the Information Desk or by emailing [info@modernartoxford.org.uk](mailto:info@modernartoxford.org.uk).